

FOR LEASE OR BUILD-TO-SUIT

135TH & GREENWOOD | OLATHE, KS



SITE SUMMARY:

- 55,000 SF PAD
- ANCHORED BY WALMART, HOBBY LOBBY, ACADEMY SPORTS
- LAST REMAINING PAD
- EXCELLENT VISIBILITY & ACCESS



Bob Johnson | (816) 268-2450
bjohnson@rhjohnson.com

Bryan Jantsch | (816) 268-2455
bjantsch@rhjohnson.com

RHJOHNSON.COM • 816.561.5111 • 4520 MADISON AVENUE, SUITE 300 • KANSAS CITY, MO 64111

While this information is deemed correct, no representation is made as to the accuracy thereof. This information is subject to errors, omissions, and change of terms at any time. The property may be withdrawn from the market without notice.

SITE PLAN

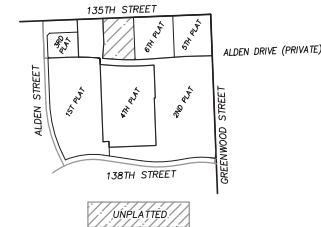

LOCATION MAP

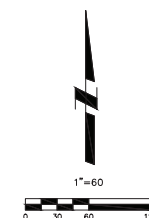

SALES MAP

| | | |
|--|--------------------------|-------|
| PROJECT NO. 17-0004 | | |
| ALDEN CENTER | | |
| 135TH STREET & ALDEN STREET | | |
| Payne & Brockway P.A. | | |
| CIVIL ENGINEERS & LAND SURVEYORS | | |
| 420 SOUTH KANSAS AVE., OMAHA, NE 68102 | | |
| PH: 402.781.8000 FAX: 402.781.8001 | | |
| WWW.PAYNE-BROCKWAY.COM | | |
| DATE | SCALE | SHEET |
| 8/30/18 | HOR: 1"=60' VERT: N/A | 1 |



SUMMARY PROFILE

2000-2010 Census, 2020 Estimates with 2025 Projections

Calculated using Weighted Block Centroid from Block Groups

Lat/Lon: 38.8835/-94.7609

RS1

W 135th St & S Black Bob Rd

| | | 1 mi radius | 3 mi radius | 5 mi radius |
|---------------------|---|-------------|-------------|-------------|
| POPULATION | 2020 Estimated Population | 10,402 | 106,174 | 217,675 |
| | 2025 Projected Population | 10,936 | 111,236 | 228,315 |
| | 2010 Census Population | 9,618 | 100,299 | 192,560 |
| | 2000 Census Population | 7,255 | 82,611 | 151,904 |
| | Projected Annual Growth 2020 to 2025 | 1.0% | 1.0% | 1.0% |
| | Historical Annual Growth 2000 to 2020 | 2.2% | 1.4% | 2.2% |
| | 2020 Median Age | 35.1 | 35.1 | 35.9 |
| HOUSEHOLDS | 2020 Estimated Households | 3,786 | 40,040 | 83,027 |
| | 2025 Projected Households | 3,981 | 41,974 | 87,086 |
| | 2010 Census Households | 3,429 | 36,375 | 71,172 |
| | 2000 Census Households | 2,487 | 28,800 | 54,480 |
| | Projected Annual Growth 2020 to 2025 | 1.0% | 1.0% | 1.0% |
| | Historical Annual Growth 2000 to 2020 | 2.6% | 2.0% | 2.6% |
| RACE AND ETHNICITY | 2020 Estimated White | 80.5% | 80.8% | 80.9% |
| | 2020 Estimated Black or African American | 6.0% | 5.8% | 5.5% |
| | 2020 Estimated Asian or Pacific Islander | 8.1% | 6.2% | 6.9% |
| | 2020 Estimated American Indian or Native Alaskan | 0.3% | 0.4% | 0.4% |
| | 2020 Estimated Other Races | 5.0% | 6.7% | 6.3% |
| | 2020 Estimated Hispanic | 7.3% | 9.7% | 9.0% |
| INCOME | 2020 Estimated Average Household Income | \$102,449 | \$110,850 | \$116,563 |
| | 2020 Estimated Median Household Income | \$92,792 | \$91,117 | \$97,912 |
| | 2020 Estimated Per Capita Income | \$37,290 | \$41,867 | \$44,513 |
| EDUCATION (AGE 25+) | 2020 Estimated Elementary (Grade Level 0 to 8) | 1.2% | 2.7% | 2.4% |
| | 2020 Estimated Some High School (Grade Level 9 to 11) | 2.4% | 2.8% | 2.7% |
| | 2020 Estimated High School Graduate | 11.8% | 14.8% | 13.6% |
| | 2020 Estimated Some College | 21.6% | 19.0% | 17.7% |
| | 2020 Estimated Associates Degree Only | 8.5% | 8.3% | 8.0% |
| | 2020 Estimated Bachelors Degree Only | 35.6% | 33.4% | 34.7% |
| | 2020 Estimated Graduate Degree | 18.8% | 19.1% | 20.9% |
| BUSINESS | 2020 Estimated Total Businesses | 510 | 3,522 | 9,449 |
| | 2020 Estimated Total Employees | 5,688 | 46,808 | 126,403 |
| | 2020 Estimated Employee Population per Business | 11.2 | 13.3 | 13.4 |
| | 2020 Estimated Residential Population per Business | 20.4 | 30.1 | 23.0 |

This report was produced using data from private and government sources deemed to be reliable. The information herein is provided without representation or warranty.

